

# DEWATERING BLG – STACKED

# DEWATERING BLG – EXTENDED EAST

# DEWATERING BLG – EXTENDED WEST

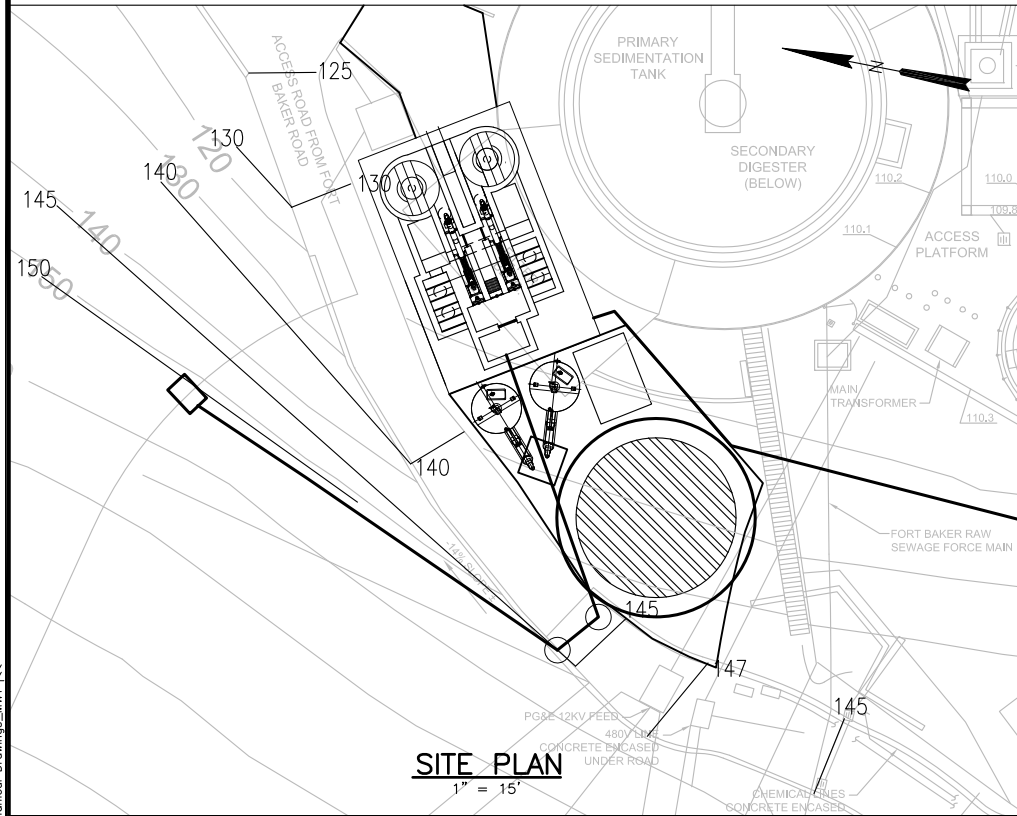

**SITE PLAN**  
1" = 15'

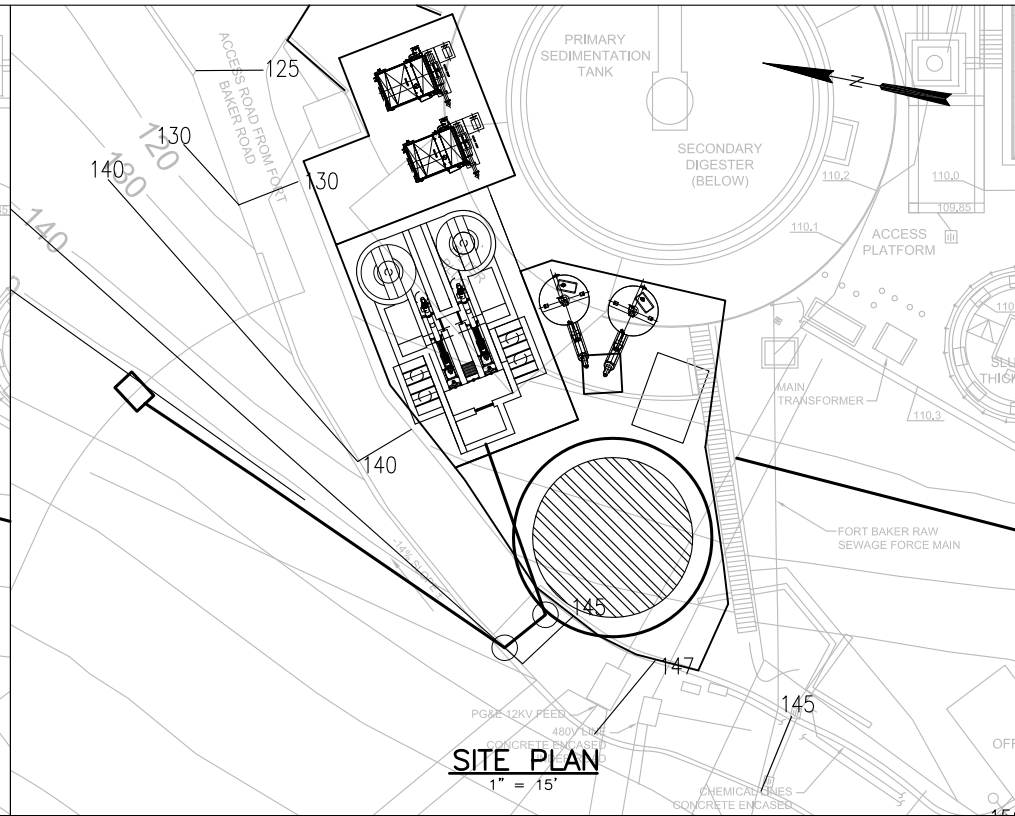

**SITE PLAN**  
1" = 15'

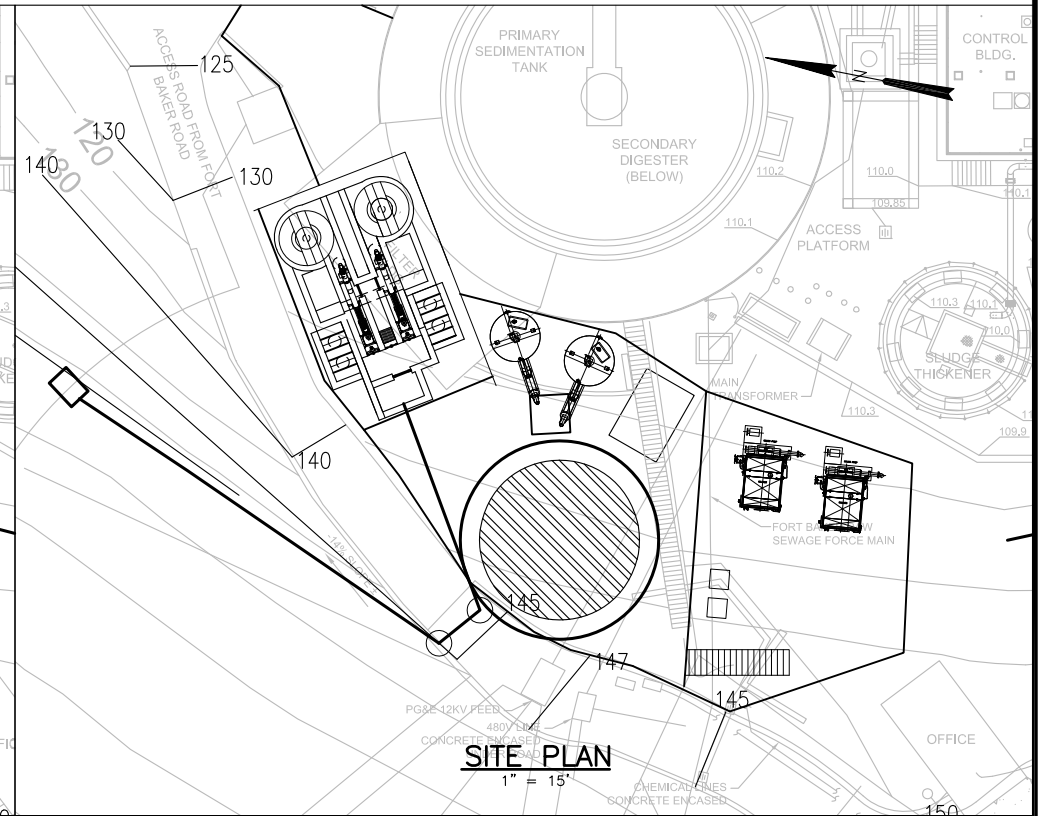

**SITE PLAN**  
1" = 15'

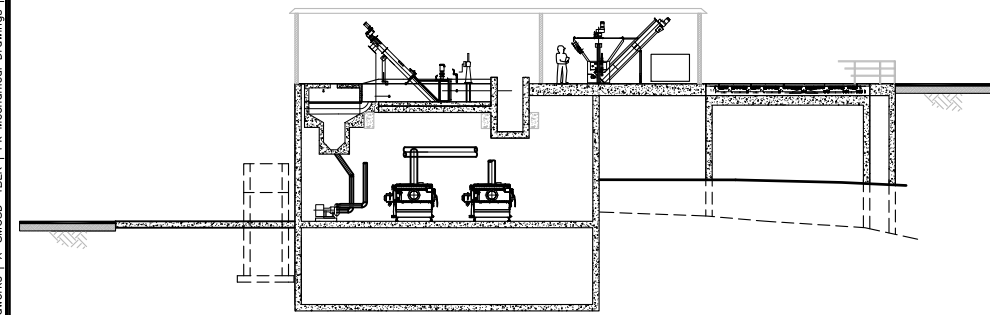

**REPRESENTATIVE SECTION**

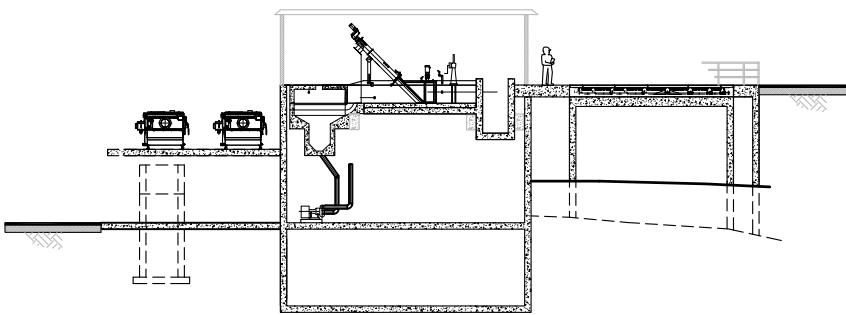

**REPRESENTATIVE SECTION**

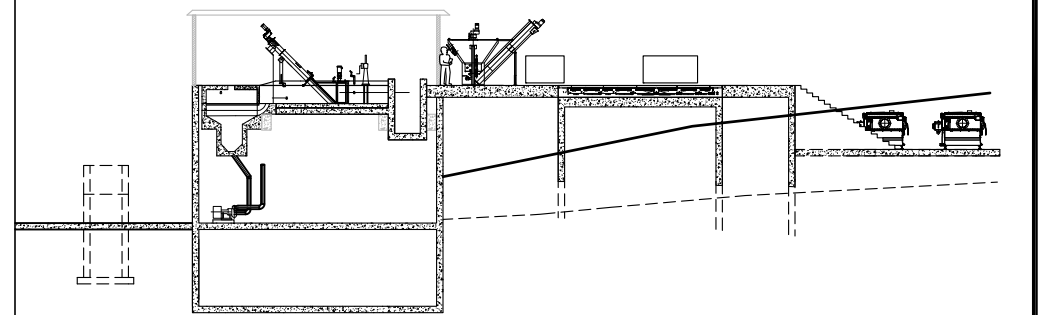

**REPRESENTATIVE SECTION**

### ADVANTAGES

- COMPACT LAYOUT
- MINIMIZES IMPACT TO EXISTING UTILITIES
- POTENTIAL VEHICLE ACCESS TO PRIMARY FILTERS

### DISADVANTAGES

- STACKED PROCESS ARRANGEMENT
- LIMITED ADDITIONAL STORAGE SPACE
- SEPERATE SCREENINGS AND GRIT BINS

### ADVANTAGES

- ADDITIONAL STORAGE SPACE
- UNSTACKED PROCESS EQUIPMENT

### DISADVANTAGES

- NO VEHICLE ACCESS TO NEW PRIMARY FILTERS
- SEPERATE SCREENINGS AND GRIT BINS

### ADVANTAGES

- MAXIMIZES USE OF AVAILABLE HILLSIDE SPACE
- UNSTACKED PROCESS EQUIPMENT
- ADDITIONAL STORAGE SPACE

### DISADVANTAGES

- HIGHEST COST
- POTENTIALLY GREATEST VISUAL IMPACT
- SEPERATE SCREENINGS AND GRIT BINS

FILENAME: Pk Civil Site Plan 10-12-11 12:31pm mtkemoto || XREFS: Pk Treatment Plant Site Plan For Headworks || X-SMSD-TBLK || Pk Mechanical Drawings || Pk Mechanical Drawings\_MWT || Cc---

0" = 1"  
— VERIFY SCALES —  
BAR IS ONE INCH  
LONG ON FULL  
SIZE DRAWING.  
IF NOT ONE INCH  
LONG ON THIS  
DRAWING, ADJUST  
SCALES ACCORDINGLY



REV	DATE	BY	APVD	DESCRIPTION
▲				
▲				
▲				

DESIGNED  
DRAWN  
CHECKED

SUBMITTED:  
RMC PROJ ENGR  
APPROVED:  
RMC ENGR

SAUSALITO - MARIN CITY SANITARY DISTRICT  
**SUMMARY OF BAYSIDE SITE PLAN ALTERNATIVES**

DWG NO **TM2-1**  
SHEET NO OF  
PROJ NO 055-003  
DATE OCTOBER 2011